

# TDL

## Twist & Dry™ Low Flow Hollow Cone

### DESIGN FEATURES

- Patent pending
- Locking mechanism for quick and easy change-out
- 2 piece body for easy maintenance
- Lower flow rates than TD series
- Female threaded or butt weld pipe connections
- Orifice size: 0.457mm through 1.47mm
- Interchangeable swirl and orifice discs for variable patterns and flow rates

### SPRAY CHARACTERISTICS

- Hollow Cone
- Flow rates:** 11.3 to 469 l/h
- Spray angle:** 70° - 75°



Female

WHIRL



70° Hollow Cone

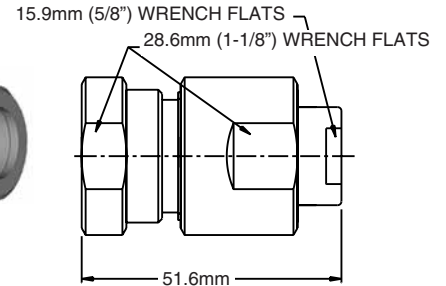

### TDL Flow Rates and Dimensions

Hollow Cone, 70° to 75° Spray Angles, 1/4" and 3/8" Pipe Size NPT, BSP or Welded

Female Pipe Size	Nozzle Number	Dia. Swirl [mm]	Dia. [mm]	K	LITERS PER HOUR @ BAR											Pipe Size	Wt. [g]	
					15 bar	35 bar	50 bar	70 bar	90 bar	100 bar	120 bar	150 bar	175 bar	200 bar	275 bar			350 bar
1/4"	TDL4-18	SW4	0.457	2.92	11.3	17.3	20.6	24.4	27.7	29.2	32.0	35.7	36.6	41.3	48.4	54.6	1/4"	119
	TDL4-20	SW4	0.508	3.10	12.0	18.3	21.9	25.9	29.4	31.0	34.0	38.0	41.0	43.8	51.4	58.0		
	TDL4-22	SW4	0.559	3.42	13.2	20.2	24.2	28.6	32.4	34.2	37.4	41.9	45.2	48.3	56.7	64.0		
	TDL4-24	SW4	0.610	3.92	15.2	23.2	27.7	32.8	37.2	39.2	42.9	48.0	51.9	55.4	65.0	73.3		
	TDL4-27	SW4	0.686	4.56	17.7	27.0	32.2	38.1	43.2	45.6	49.9	55.8	60.3	64.5	75.6	85.3		
OR	TDL1-22	SW1	0.559	5.01	19.4	29.7	35.5	41.9	47.6	50.1	54.9	61.4	66.3	70.9	83.1	93.8	3/8"	107
	TDL1-24	SW1	0.610	5.70	22.1	33.7	40.3	47.7	54.0	57.0	62.4	69.8	75.4	80.6	94.5	107		
	TDL1-27	SW1	0.686	6.61	25.6	39.1	46.7	55.3	62.7	66.1	72.4	80.9	87.4	93.5	110	124		
	TDL1-30	SW1	0.762	7.52	29.1	44.5	53.2	62.9	71.3	75.2	82.4	92.1	99.5	106	125	141		
3/8"	TDL2-30	SW2	0.762	9.12	35.3	53.9	64.5	76.3	86.5	91.2	100	112	121	129	151	171	3/8"	107
	TDL2-33	SW2	0.838	10.3	39.7	60.7	72.5	85.5	97.3	103	112	126	136	145	170	192		
	TDL2-36	SW2	0.914	11.4	44.1	67.4	80.6	95.3	108	114	125	140	151	161	189	213		
	TDL2-38	SW2	0.965	12.1	46.8	71.5	85.4	101	115	121	132	148	160	171	200	226		
	TDL2-40	SW2	1.02	13.2	51.2	78.2	93.5	111	125	132	145	162	175	187	219	247		
	TDL2-42	SW2	1.07	13.7	53.0	80.9	96.7	114	130	137	150	167	181	193	227	256		

$$\text{Flow Rate (l/hr)} = K \sqrt{\text{BAR}}$$

Standard Materials: Stainless Steel, Tungsten Carbide. Other materials available.

TO ORDER: specify pipe size, connection type, nozzle number and material.



70° Hollow Cone

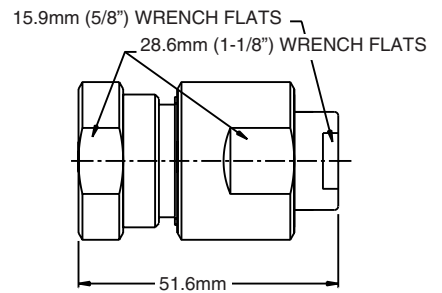

**TDL Flow Rates and Dimensions**

Hollow Cone, 70° to 75° Spray Angles, 1/4" and 3/8" Pipe Size NPT, BSP or Welded

Female BSP Pipe Size	Nozzle Number	Swirl	Dia. (mm)	K	LITERS PER HOUR @ BAR											Pipe Size	Wt (g)	
					15 bar	35 bar	50 bar	70 bar	90 bar	100 bar	120 bar	150 bar	175 bar	200 bar	275 bar			350 bar
1/4"	TDL2-44	SW2	1.12	14.1	54.7	83.6	100	118	134	141	155	173	187	200	234	264	1/4"	119
	TDL2-46	SW2	1.17	14.8	57.4	87.6	105	124	141	148	162	181	196	209	246	277		
	TDL2-48	SW2	1.22	16.0	61.8	94.4	113	133	151	160	175	195	211	226	265	298		
	TDL2-50	SW2	1.27	16.6	64.4	98.4	118	139	158	166	182	204	220	235	276	311		
	TDL2-52	SW2	1.32	18.0	69.7	107	127	151	171	180	197	220	238	255	298	337		
OR	TDL2-54	SW2	1.37	18.7	72.4	111	132	156	177	187	205	229	247	264	310	350	3/8"	107
	TDL2-56	SW2	1.42	19.1	74.1	113	135	160	182	191	210	234	253	271	317	358		
3/8"	TDL3-50	SW3	1.27	20.4	79.1	121	144	171	194	204	224	250	270	289	339	382	3/8"	107
	TDL3-52	SW3	1.32	21.8	84.4	129	154	182	207	218	239	267	288	308	361	408		
	TDL3-54	SW3	1.37	23.0	89.1	136	163	193	218	230	252	282	304	326	382	431		
	TDL3-56	SW3	1.42	24.4	94.4	144	172	204	231	244	267	299	323	345	404	456		
	TDL3-58	SW3	1.47	25.1	97.1	148	177	210	238	251	275	307	332	355	416	469		

Flow Rate (l/hr) = K √BAR

Standard Materials: Stainless Steel, Tungsten Carbide. Other materials available.

CALL 1-413-772-2166  
Call for the name of your nearest BETE representative.